



Water Row, High Street, Ware SG12 9BW

£1,600

Taylor Phelps

Estate Agency



2



1

Taylor Phelps

Estate Agency

Floor Plan

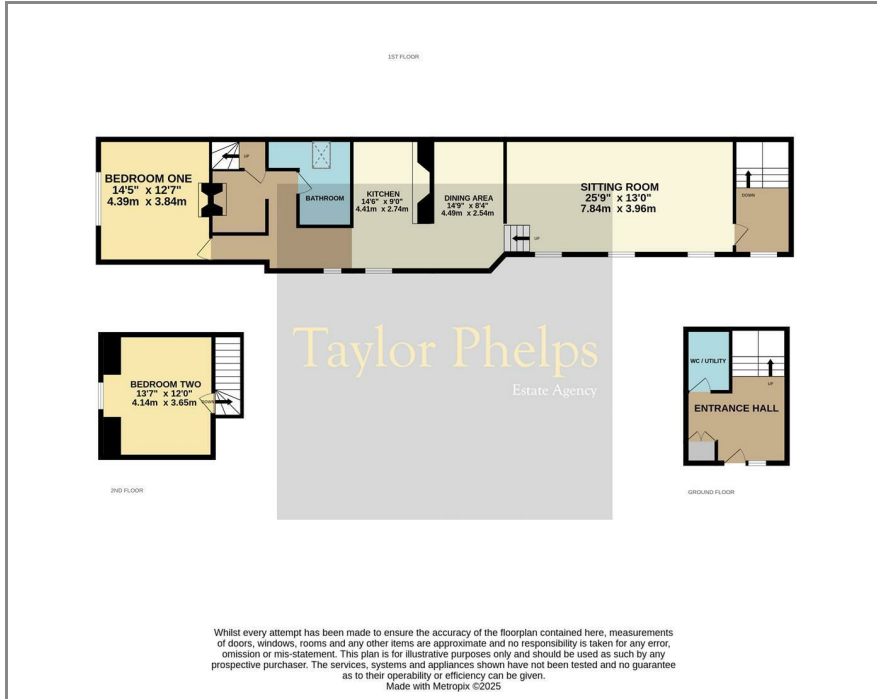

Area Map

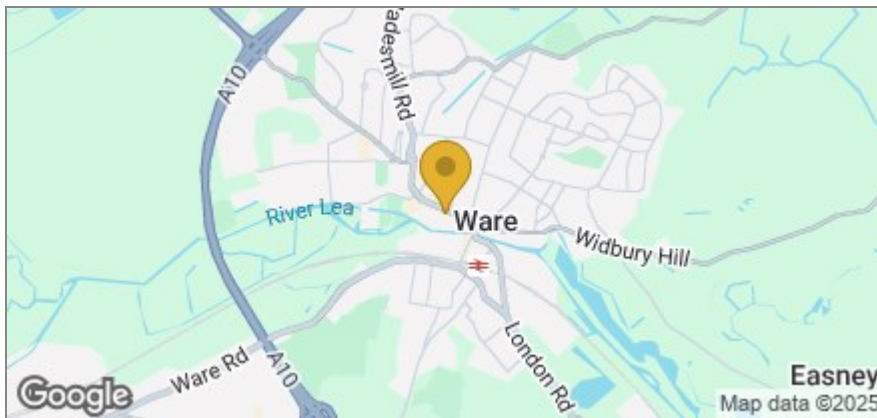

Taylor Phelps are delighted to offer this magnificent period home forming part of this private mews in the heart of Ware town centre. This unique and historic property has been featured in several exclusive property magazines and boasts a wealth of character features throughout with the most impressive cathedral style living space, two double bedrooms, two modern bathrooms and a beautiful inglenook fireplace. Grade II Listed.



Energy Efficiency Graph

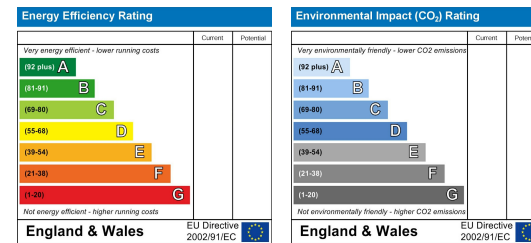

These particulars, whilst believed to be accurate are set out as a general outline only for guidance and do not constitute any part of an offer or contract. Intending purchasers should not rely on them as statements of representation of fact, but must satisfy themselves by inspection or otherwise as to their accuracy. No person in this firm's employment has the authority to make or give any representation or warranty in respect of the property.

01920 459000

hello@taylorphelps.co.uk

5 Frenchs Yard, Amwell End, Ware, Hertfordshire, SG12 9HP

www.taylorphelps.co.uk

